

# Timberline

By ELWELL



## Products & Parts Catalog

2022

**Timberline**

Heat & Hot Water System



Autoterm Air Heaters

# Contents

## Timberline Heat & Hot Water System

Presenting Timberline	1
Timberline Heaters	3
System Overview	4

## Timberline Parts & Accessories

Heater Accessories	7
Hot Water	8
Fuel System	9
Electrical	10
Tank & Plumbing	11
Heating, Diagnostics	12

## Autoterm Heating Systems

Autoterm Air Heaters	15
Autoterm Controllers	17

## Autoterm Parts & Accessories

Air Ducting	19
Fuel, Exhaust & Intake	22
Electrical, Mounting, Diagnostics	24

## Elwell Corporation and Advers/Autoterm's partnership

25



Rugged. Refined. Luxury.

# Timberline

## PREMIUM HEAT & HOT WATER SYSTEM

*Ideal for Class B and C Motorhomes.*



Diesel/  
Gasoline



Seamless High  
Altitude Function



Quiet  
Heat



Continuous  
Hot Water



Clean &  
Efficient

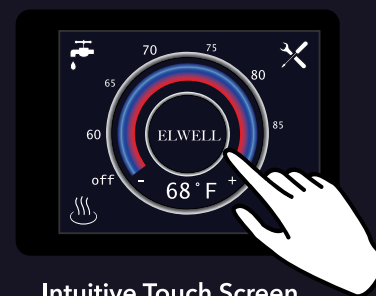

Intuitive Touch Screen

TIMBERLINEHEAT.COM  
ELWELLCORP.COM

BY ELWELL

360-608-0916

## Presenting Timberline:

Timberline is an intentionally designed heat and hot water system that brings the luxuries of home to the rugged outdoors. Whether your adventures take you skiing in the mountains of Colorado or beach-combing in Florida, radiant enveloping comfort and hot showers will welcome you back at your motorhome.

### SYSTEM OPERATION

Timberline heat and hot water is generated by the Autoterm Binar Compact, a powerful but quiet diesel or gasoline heating unit made for the most adverse conditions. A heated glycol solution is circulated through the interior of the living space through quiet air handlers that provide soft radiant heat. The glycol is also circulated through an instantaneous water heat exchanger which produces hot water for showers and kitchen use.

By using the diesel or gasoline burner coupled with 110V electric element support, Timberline provides efficient comfort whether dry camping or plugged into shore power. When the RV is cold the fans run on high until the interior temperature starts to reach its target. The fans then automatically slow down and remain on low levels, maintaining the comfort levels inside.

The Timberline touchscreen digital panel located inside the RV gives you full control of your interior temperature. The controls are intuitive and easily allow you to adjust how hard or soft you want the heat to distribute and whether you want to utilize your fuel source or electric only.

# TIMBERLINE HEATERS



**TIMBERLINE HEAT & HOT WATER SYSTEM 17,000 BTU Hydronic Heaters**

## DIESEL

Binar-5D Hydronic Coolant Heater  
Part# A17000-D1

### Binar-5D Specifications

Technical Parameters	Diesel
Voltage	12V or 24V
Heating medium	Coolant, antifreeze coolant
Heating power	5 kW
Optimal liquid/coolant volume	10 - 12 L
Power consumption	45 - 70 W
Fuel	Diesel
Fuel consumption, max	0.60 l/h
Control Mode	Touchscreen
Weight	7 lb
Heater dimensions	9.5 x 4.3 x 7.1 in

## GASOLINE

Binar-5B Hydronic Coolant Heater  
Part# A17000-G1

### Binar-5B Specifications

Technical Parameters	Gasoline
Voltage	12V or 24V
Heating medium	Coolant, antifreeze coolant
Heating power	5 kW
Optimal liquid/coolant volume	10 - 12 L
Power consumption	45 - 70 W
Fuel	Gasoline
Fuel consumption, max	0.70 l/h
Control Mode	Touchscreen
Weight	7 lb
Heater dimensions	9.5 x 4.3 x 7.1 in

# SYSTEM OVERVIEW

## Timberline Expansion Tank

Expansion Tank AC Backup

14.5"W x 6.75"D x 9"H

Item A. (See Page 6)

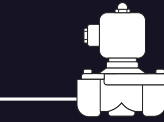
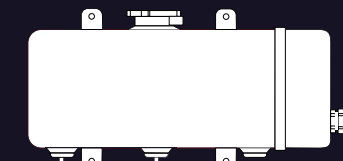

**Solenoid (Optional)**  
5.5"W x 2.25"D x 4.5"H  
Item B. (See Page 6)

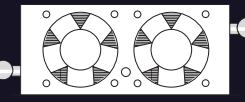

**Cabin Fan**  
13"W x 7.75"D x 4"H  
Item C. (See Page 6)



**Circulation Pump**  
3.5"L x 2.5"D x 3.5"H  
Item D. (See Page 6)

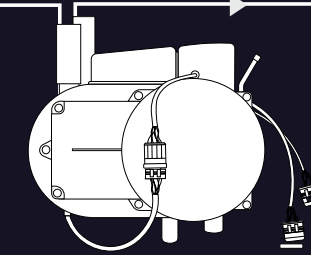

**Binar D5 Heater**  
9.75"W x 4"D x 6"H  
Item E. (See Page 6)

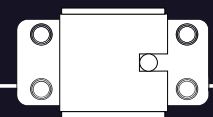

**Hot Water Heat Exchanger**  
7.75"W x 4"D x 3.5"H  
Item F. (See Page 6)

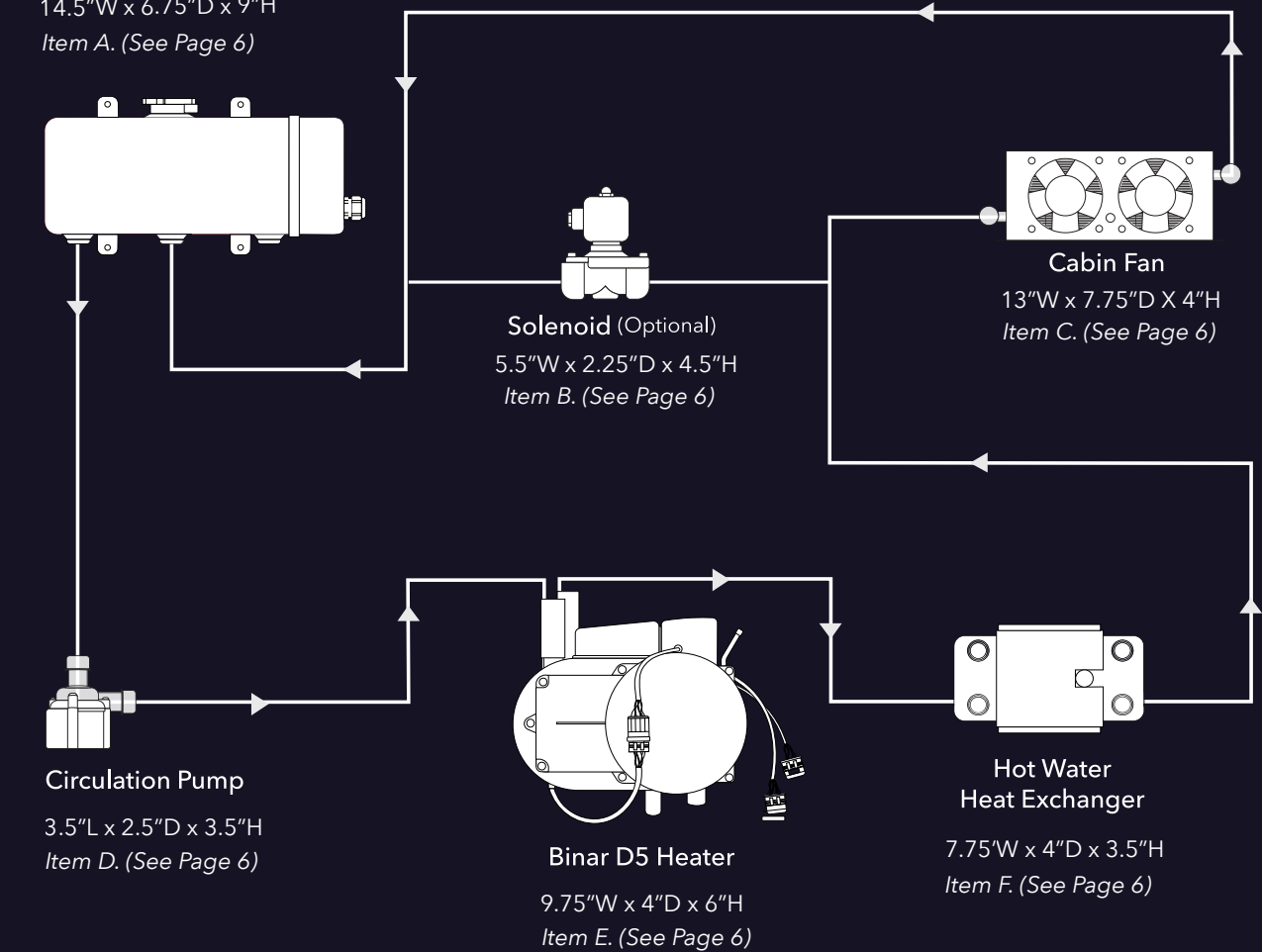

## SYSTEM SPECIFICATIONS

**Hot Water Performance:**  
Continuous on-demand

**Power:**  
8000-17000 Btu (Diesel)  
5000 Btu (Electric)

**Weight:**  
Less than 30 lbs

**Power Consumption:**  
12V: 5 amps,  
120V: 12.5 amps



### INTUITIVE TOUCH SCREEN

The Timberline touchscreen panel located inside the RV gives you full command of your interior temperature with intuitive and easy to use controls. The panel allows you to adjust how hard or soft you want the heat to distribute and whether you want to utilize your fuel source or electric only, along with many more options to regulate the heating to your liking.

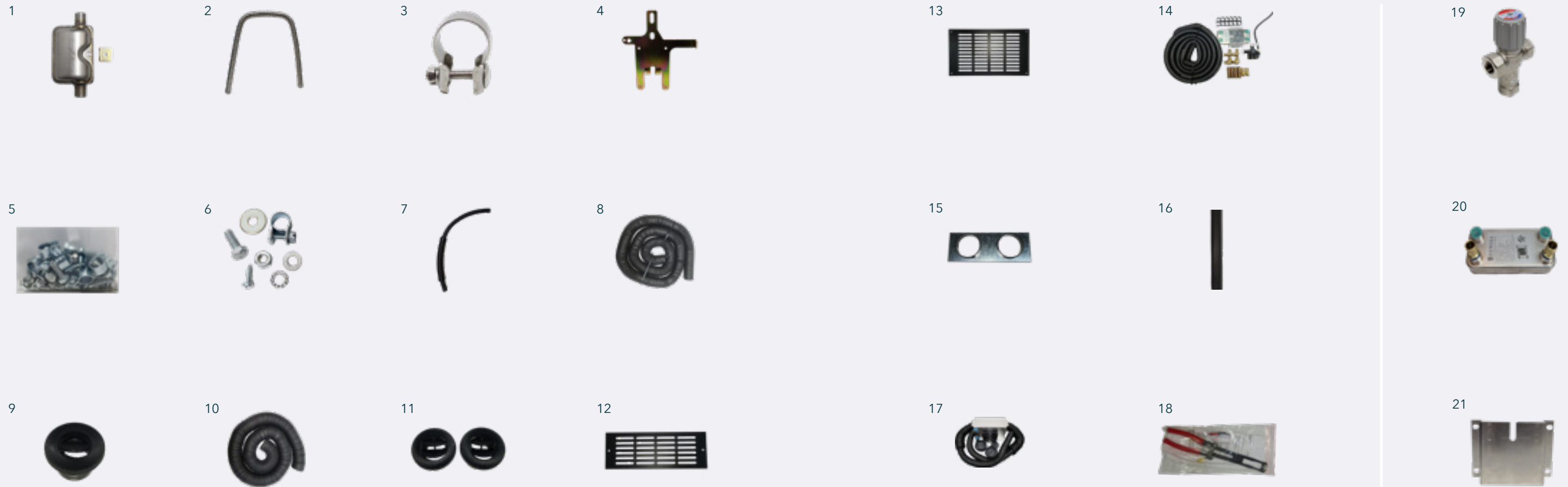

**HEATER ACCESSORIES**

- 1 Exhaust Muffler 24mm  
Part#: A30100
- 2 Exhaust Tubing 24mm (With End Cap)  
Part#: A30101
- 3 Exhaust Clamp 24mm  
Part#: A30102
- 4 Timberline/Autoterm Binar Bracket  
Part#: A60110
- 5 Timberline Installation Hardware  
Part#: A60100
- 6 Timberline Install Screw Pack  
Part#: A60100
- 7 Timberline Air Intake  
Part#: A30600
- 8 2 Inch Ducting  
Part#: A10300-2005  
Length: 8'
- 9 2 Inch Vent  
Part#: A10300-2001
- 10 3 Inch Ducting  
Part#: A8018  
Length: 8'
- 11 3 Inch Vents  
Part#: A1051
- 12 Black Anodized Plate  
Part#: A-1057  
Size: 10" L x 4"W

- 13 Black Anodized Plate  
Part#: A1049  
Dimensions: 10" L x 6"W
- 14 Engine Heat Loop Kit  
Part#: A11600
- 15 Duct Plate for Toe-kick  
Part#: A10281  
Port Diameter: Ø 3"
- 16 Exhaust Heat Shield  
Part#: B1000-909  
Length: 18"
- 17 Ducting Kit for Toe-kick  
Part#: A230-JAY00
- 18 Spring Clamp Pliers (Straight)  
Part#: go-323  
(Swivel)  
Part#: go-322

**HOT WATER**

- 19 Timberline Mixing Valve  
Part#: A10250
- 20 Potable Double Wall Heat Exchanger  
Part#: A10200
- 21 Potable Double Wall Heat Exchanger Bracket  
Part#: A10201



**FUEL SYSTEM**

- 22 Gasoline Fuel Pump (Thomas)  
Part#: A9000-P327-12
- 23 Fuel Pump Bracket  
Part#: A15101
- 24 Hose Barb to FPT  
Part#: 126HBL-5-2  
3/4" barb x 1/2" FPT
- 25 Fuel Line Adapter  
Part#: EL-00050-06-20  
5/16" barb x 3/16" barb
- 26 Fuel Line Roll  
Part#: A15200
- 27 Fuel Adapters  
Part#: A15201
- 28 Diesel Fuel Pump  
Part#: A15100
- 29 7/16 Fuel Hose Clamp  
Part#: Fuel-30075
- 30 5/16 Fuel Hose  
Part#: Fuel-30095  
Length: 10'
- 31 3/16 Fuel Hose  
Part#: Fuel-30085  
Length: 10'
- 32 1/4 to 5/16 Fuel Adapter  
Part#: Fuel-30101

**ELECTRICAL**

- 33 Timberline Touchscreen Control Panel  
Part#: A20100
- 34 Touch Screen Extension  
Part#: A2033-10  
Length: 10'
- 35 System Temp Sensor  
Part#: A20500
- 36 Fan Harness  
Part#: A2031  
Length: 5'
- 37 Fan Harness Extension  
Part#: A2031-15  
Length: 15'
- 38 Timberline Control Box  
Part#: A20200
- 39 Room Temp Sensor  
Part#: A20501  
Length: 6' 5"
- 40 Room Temp Sensor Cover  
Part#: A20505
- 41 Air Sensor Extension  
Part#: A2034-10
- 42 Main Electrical Harness  
Part#: A20300
- 43 Heater Harness Extension  
Part#: A2036-10  
Length: 10'
- 44 Timberline Standard Harness  
Part#: A2030-W1000



## TANK & PLUMBING

- |   |  |  |
|---|--|--|
| 45 Timberline 1500W<br>110V 2 Gal Tank<br>Part#: A10100           | 51 Hex Head Plug Cored<br>Part#: 218P-8<br>1/2" MPT Plug | 56 3/4 x 3/4 Hose Barb<br>Elbow<br>Part#: A10501                   |
| 46 Tank Element<br>Part#: CAMCO02463                              | 52 27mm Constant<br>Tension Clamp<br>Part#: A30103       | 57 3/4 x 5/8 Hose Barb<br>Reducer<br>Part#: A10502                 |
| 47 Timberline Coolant<br>Circulation Pump<br>Part#: A10400        | 53 2 Way Electric Valve<br>Open<br>Part#: A10350         | 58 Hose Barb Tee<br>Part#: 1791212C<br>3/4" x 3/4" x 3/4" Barb Tee |
| 48 Circulation Pump Bracket<br>Part#: A10401                      | 54 2 Way Electric Valve<br>Closed<br>Part#: A15200       | 59 Hose Coupler<br>Part#: A10600-111<br>3/4" x 3/4" Barb Coupler   |
| 49 Hose Barb to MPT<br>Part#: 125HBL-12-8<br>3/4" barb x 1/2" MPT | 55 Rubber Hose with U<br>Part#: A15201                   | 60 Radiator Cap<br>Part#: 703-1696                                 |
| 50 Hose Barb to MPT<br>Part#: 125HBL-3-2<br>3/16" barb x 1/8" MPT |  |  |



## HEATING

- |   |   |
|---|---|
| 61 Timberline Toekick<br>Part#: A10300-6132<br>Size: 13"L x 7 1/2"W x 3 3/4"H<br>Specs: 8000 BTUs | 62 Binar Heater<br>(Gasoline)<br>Part#: A17000-G1<br>Size: 10"L x 8"W x 5"H<br><br>(Diesel)<br>Part#: A17000-D1<br>Size: 10"L x 8"W x 5"H |
|---|---|

## DIAGNOSTICS

- |   |   |
|---|---|
| 63 Cabin Fan-Kit<br>Part#: A10300-6002233<br>Size: 11 1/2"L x 7W x 6 1/4"H<br>Specs: 9000 BTUs<br><br>Includes:<br>9000 BTU Cabin Fan<br>Duct Plate<br>Two 3" Hoses<br>One 2" Hose<br>Two 3" Outlets<br>One 2" Outlet | 64 Fuel Pump Tester<br>and Booster<br>Part#: 3455 |
|---|---|





# Explore even the harshest climates.

## **AUTOTERM Air Heaters** Siberian-tested Heating Systems

AUTOTERM heaters are independent gasoline/diesel powered heating systems that can be easily installed or retrofitted into your vehicle.

Liquid heaters are specifically designed to pre-heat your vehicle's engines and compartments, thus eliminating cold start of the engine and supplying comfortable warm air to passenger compartments in cold conditions. They can also be used to heat central heating systems with radiators and boilers.

Air heaters are excellent products for spaces which need to be heated quickly, or where there is no built in central heating system. For example: campers, boats, Etc.

All heaters feature built in fail-safe systems and sensors. The self diagnostic system will automatically shut down the heater if it encounters any errors (such as battery drain, over-heating of the heater, low fuel level, air pump malfunction, or flame failure) making it a completely safe product.

AUTOTERM Air series heaters are also equipped with brush-less induction motors that ensure low noise levels as well as a long lifetime for your device, and the ability to operate in extreme temperatures as low as -45°C/-49°F.

# AUTOTERM AIR HEATERS



## AUTOTERM Air 2D

For Small Spaces

Heater Specifications		
Technical Parameters	High	Low
Voltage	12V or 24V	
Heating Power	2.0 kW	0.8kW
Power Consumption	29 W	10 W
Fuel	Diesel	
Fuel Consumption	0.06 g/h	0.03 g/h
Control Mode	Manual, Remote, Modem	
Weight	6.3 lb	
Heater Dimensions	12.2 x 4.7 x 5.7 in	

- Extremely compact
- Maximum heating power 6800 BTUs for 12V or 24V model
- Able to heat up to 3000 ft<sup>3</sup> in one hour
- Excellent fuel economy at 0.06 gal/hour
- Suited to additionally heat small truck cabins, commercial vehicles, small campers, off-highway vehicles or boats of up to 33 ft.

## AUTOTERM Air 4D/4B

For Medium Spaces

Heater Specifications		
Technical Parameters	High	Low
Voltage	12V or 24V	
Heating Power	4.0 kW	1.0kW
Power Consumption	57 W / 56 W	10 W
Fuel	Gasoline/Diesel	
Fuel Consumption	0.13 g/h	0.03g/h
Control Mode	Manual, Remote, Modem	
Weight	12 lb	
Heater Dimensions	15.8 x 6.2 x 7.4 in	

- Highly versatile installation
- Maximum heating power 13,600 BTUs for 12V or 24V model
- Able to heat and maintain the temperature in a 5900 ft<sup>3</sup> space
- Excellent fuel economy at 0.13 gal/hour
- Suited for large truck cabins, commercial vehicles, campers, motorhomes or boats/yachts of up to 48 ft.

## AUTOTERM Air 8D

For Large & Commercial Spaces

Heater Specifications		
Technical Parameters	High	Low
Voltage	12V or 24V	
Heating Power	6 kW / 7.5 kW	3.2kW
Power Consumption	75W / 90W	8W/9W
Fuel	Diesel	
Fuel Consumption	0.2g/h / 0.24g/h	0.11g/h
Control Mode	Manual, Remote, Modem	
Weight	25.5 lb	
Heater Dimensions	21.6 x 8.2 x 11.6 in	

- The Autoterm 8D is designed for large spaces that do not require ductwork. The heater will bring large open spaces up to temperature quickly and maintain the set temperatures easily.
- Maximum heating power 20,000 BTUs for 12V models; 23,600 BTUs for 24V models.
- Able to heat a 11,800 ft<sup>3</sup> space hourly
- For use in large vehicles and commercial spaces, including cargo holds, shipping containers and large, open mobile workspaces.

## AUTOTERM Air 9D

For Large & Commercial Spaces

Heater Specifications		
Technical Parameters	High	Low
Voltage	12V or 24V	
Heating Power	8 kW	3.2kW
Power Consumption	290 W / 210 W	12 W
Fuel	Diesel	
Fuel Consumption	0.26 g/h	0.11 g/h
Control Mode	Manual, Remote, Modem	
Weight	28.2 lb	
Heater Dimensions	25.6 x 8.3 x 11 in	

- Equipped with high-strength steel double circuit heat exchanger for best heat distribution
- Maximum heating power 27,000 BTUs
- Able to heat and maintain the temperature in a 14,500 ft<sup>3</sup> space
- For heating large spaces such as commercial vehicle cargo compartments, buses, large motorhomes, specialty vehicles or boats up to 65 feet/20 m.

## AUTOTERM CONTROLLERS



### 1 Control Panel **PU-28**

The PU-28 is an integrated easy to use color touch-screen that is compatible with all AUTOTERM air heaters. The software allows for different comfort control methods and has full self diagnostics included. Bluetooth functionality comes standard with the PU-28.

### 2 Control Panel **PU-27**

The PU-27 is compatible with AUTOTERM 2D, 4D, 8D, 9D Air Heaters and AUTOTERM Flow 14D Liquid Heaters. This control panel has an OLED screen that does not freeze at low temperatures and has an integrated temperature sensor.

### 3 Control Panel **PU-5**

The PU-5 control panel features four simple controls and is compatible with all AUTOTERM air heaters.

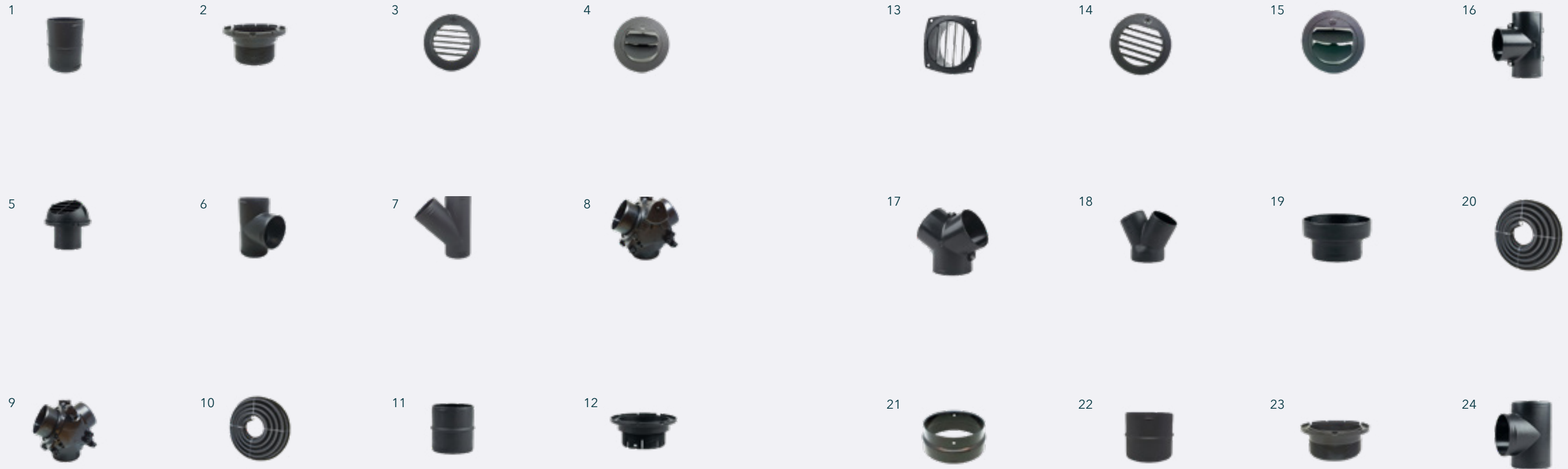

## AIR DUCTING

**1 Air Ducting Connector**

Part#: P5004  
Diameter: Ø 60mm

**2 Air Ducting Flange**

Part#: P4931  
Diameter: Ø 60 mm

**3 Air Ducting Slanted Grill**

Part#: P4943  
Diameter: Ø 60mm 30°

**4 Air Ducting Closable Grill**

Part#: 4099  
Diameter: Ø 60 mm

**5 Air Ducting Adjustable Grill**

Part#: DE033  
Diameter: Ø 60 mm

**6 Air Ducting T**

Part#: P5008  
Diameter: Ø 60 mm

**7 Air Ducting Street Y**

Part#: P5006  
Diameter: Ø 60 mm 45°

**8 Air Ducting Y (Control Valve)**

Part#: FR011  
Diameter: Ø 60 mm

**9 Air Ducting Y (No Control Valve)**

Part#: FR010  
Diameter: Ø 60 mm

**10 Air Ducting**

Part#: DE013  
Diameter: Ø 60 mm

**11 Air Ducting Connector**

Part#: DE017  
Diameter: Ø 75 mm

**12 Air Ducting Flange**

Part#: DE005  
Diameter: Ø 75 mm

**13 Air Ducting Grill**

Part#: 2534  
Diameter: Ø 75 mm

**14 Air Ducting Slanted Grill**

Part#: P4944  
Diameter: Ø 75/90 mm 30°

**15 Air Ducting Closable Grill**

Part#: 4108  
Diameter: Ø 75/90 mm

**16 Air Ducting T**

Part#: 2563-01  
Diameter: Ø 75 mm

**17 Air Ducting Y**

Part#: 2687  
Diameter: Ø 75 mm

**18 Air Ducting Y**

Part#: DE025  
Diameter: Ø 75-2\*60 mm

**19 Air Ducting Adapter**

Part#: DE031  
Diameter: Ø 75-60 mm

**20 Air Ducting**

Part#: DE014  
Diameter: Ø 75 mm

**21 Air Ducting Adapter (Intake Air 4D)**

Part#: P5313  
Diameter: Ø 80-90 mm

**22 Air Ducting Connector**

Part#: P5003  
Diameter: Ø 90 mm

**23 Air Ducting Flange**

Part#: P4942  
Diameter: Ø 90 mm

**24 Air Ducting T**

Part#: DE026  
Diameter: Ø 90mm

25



26



27



28



37



38



43



29



30



31



32



39



40



44



33



24



25



36



41



42



45



## AIR DUCTING

- |  |  |   |
|--|--|---|
| 25 Air Ducting Street Y<br>Part#: P5009<br>Diameter: Ø 90mm            | 29 Air Ducting Adapter<br>Part#: DE030<br>Diameter: Ø 90-75 mm     | 33 Air Ducting Connector<br>Part#: DE036<br>Diameter: Ø 100 mm  |
| 26 Air Ducting Street Y<br>Part#: DE055<br>Diameter: Ø 90-60-90 mm     | 30 Air Ducting Adapter (4D)<br>Part#: 2509<br>Diameter: Ø96-Ø75 mm | 34 Air Ducting Adapter<br>Part#: DE034<br>Diameter: Ø 100-90 mm |
| 27 Air Ducting Y Adapter<br>Part#: DE041<br>Diameter: Ø 90-2x60 mm     | 31 Air Ducting Adapter<br>Part#: 2509<br>Diameter: Ø 96-90 mm      | 35 Air Ducting<br>Part#: DE035<br>Diameter: Ø 100 mm            |
| 28 Air Ducting Y Adapter<br>Part#: DE029<br>Diameter: Ø 90-2*75mm 120° | 32 Air Ducting<br>Part#: DE015<br>Diameter: Ø 90 mm                | 36 Air Flow Regulator with Cable<br>Part#: FR054<br>Length: 59" |

## FUEL

- |   |   |
|---|---|
| 37 7 Liter Fuel Tank<br>Part#: 290<br>Capacity: 7 litres                        | 41 Marine Fuel Kit<br>Part#: AT0041<br>AUTOTERM Marine fuel kits designed to be used only with AUTOTERM Air and Flow heaters. |
| 38 13 Liter Fuel Tank<br>Part#: 1064<br>Capacity: 13 litres                     | 42 Fuel Tank Cap<br>Part#: 1687<br>Replacement cap for AUTOTERM 7L and 13L fuel tanks.  |
| 39 Fuel T Connector (Air 2D, 4D, Binar 5)<br>Part#: P143<br>Size: 8mm*5.3mm*8mm |   |
| 40 Fuel Filter<br>Part#: 3763   |   |

## EXHAUST & INTAKE

- |  |
|--|
| 43 Heat Cover for Exhaust Pipe<br>Part#: A15101<br>Diameter: Ø 24 mm |
| 44 Exhaust Elbow<br>Part#: P5198<br>Diameter: Ø 24 mm                |
| 45 Exhaust Thruhull<br>Part#: 2385<br>Diameter: Ø 24 mm              |



**EXHAUST & INTAKE**

- |  |   |   |
|--|---|---|
| <p>46 Exhaust Thruhull<br/>Stainless Steel<br/>Part#: AT0003<br/>Diameter: Ø 24 mm</p> | <p>50 Air Intake Hose Extension<br/>Part#: 1498<br/>Length: 30"</p>                   | <p>54 Exhaust Thruhull<br/>Part#: AT0012<br/>Diameter: Ø 38 mm</p>                    |
| <p>47 Exhaust Thruhull Extended<br/>Part#: AT0013<br/>Diameter: Ø 24 mm</p>            | <p>51 Exhaust Drain<br/>Part#: 3182<br/>Diameter: Ø 24 mm</p>                         | <p>55 Exhaust Silencer<br/>Stainless Steel<br/>Part#: DE044<br/>Diameter: Ø 38 mm</p> |
| <p>48 Exhaust Thruhull Angled<br/>Part#: AT0008<br/>Diameter: Ø 24 mm</p>              | <p>52 Intake Thruhull Stainless<br/>Part#: 2405<br/>Diameter: Ø 24 mm</p>             | <p>56 Exhaust Silencer Kit<br/>Part#: 3064<br/>Diameter: Ø 24 mm</p>                  |
| <p>49 Exhaust Insulation 36"<br/>Part#: DE053<br/>Diameter: Ø 24 mm</p>                | <p>53 Exhaust Silencer<br/>Stainless Steel<br/>Part#: DE043<br/>Diameter: Ø 24 mm</p> |   |



**ELECTRICAL**

- 57 Control Panel  
Harness Extension  
Part#: P5198  
Length: 100"

**MOUNTING**

- 59 Stainless Steel  
Mounting Bracket  
(2D, 4D)  
Part#: AT0025

**DIAGNOSTICS**

- 60 Fuel Pump Tester  
and Booster  
Part#: 3455



## Timberline— An Elwell Corporation and Advers/Autoterm partnership

### WHO IS ELWELL?

The Elwell family has worked in the RV and Marine industries since the 1990s, providing products, technical support, and mobile market applications to heating and burner companies worldwide. The principles at Elwell all started in the service sector of the industry— forming service networks and managing service and installation centers nationally. This background puts the company in a unique position to represent and develop technical integrated products. With that knowledge, Elwell Corp. branched out into sales, development, and customer representation where they have been able to be a great asset to their partners.

A number of years ago, Elwell identified the need for a robust and dependable heating and hot water system for these demanding markets. After testing and working with some of the more common, available burners, Elwell was not satisfied. That is when they came across a lesser known Russian company, Advers/Autoterm.

Although Autoterm and its parent manufacturer, Advers, was a well-known and successful company in Europe and other parts of the world, their name recognition and products were almost non-existent in North America. The Elwell brothers flew overseas and sat down with this company's founders, the Kordit family. That first meeting was the beginning of a close partnership that has since formed. A vision was born and a collaborative effort made to bring Advers/Autoterm products—the most efficient and effective heating and hot water systems in the world—to North America.

### WHO IS ADVERS/AUTOTERM?

Advers/Autoterm is a very successful and high-quality manufacturer of both air and fluid heaters for mobile platforms. Holding over 100 patents, they are one of the top air/fluid heater manufacturers in the world. Advers employs over 1000 people and has over 700 partners in over 40 countries. Advers factories are ISO certified and use the finest equipment. They are top-down integrated, which means they produce many parts internally rather than relying on sub-suppliers. Autoterm was one of the first companies to bring longer-lasting air heaters to the market when they introduced and featured their brushless motors.

### ELWELL AND ADVERS/AUTOTERM IN PARTNERSHIP

Together, Advers and Elwell produced the Timberline system; they employed the core competence of Advers in burning fuel and applied the system design and market organization of Elwell. Timberline system parts are produced in both Russia and North America. In 2020 the partnership between the Elwell and Kordit families has grown beyond just the development of the Timberline system. It now includes Autoterm North America, a joint venture with the goal of bringing all Advers/Autoterm products to North America and spanning multiple markets.

### THE TIMBERLINE SYSTEM

The Timberline system is feature-rich and provides a level of comfort and reliability that has been unavailable in the past. The versatility of the Timberline system design also allows builders to optimize space, while at the same time providing comfort without compromise.

Uniting Autoterm Binar 5, as the backbone of the system, and Elwell's Timberline design package, consumers can enjoy soft, quiet heat, as well as plenty of water, for all their adventures. The Binar 5 was specifically chosen by the founder of Advers because of its reliability in high altitude and Advers environments. Currently, customers are using the Timberline system all over the country, most often off-grid and in the harshest of weather.





**What Autoterm North America offers:**

Autoterm North America is the North American sales, service, and distribution branch of the Autoterm heating and hot water systems produced by Advers. Autoterm air and fluid heaters are built to be reliable and long-lasting, yet offered at affordable prices. The heaters are tested in the coldest environments with temperatures as low as -50F to withstand Siberia’s extremely harsh winters.

Autoterm North America provides heating solutions for many different industries including: heavy truck, bus, recreational vehicle, marine, construction and agricultural markets.

To learn more about Autoterm North America and their products, visit:  
**Autoterm-usa.com**

**Notes**

---

---

---

---

---

---

---

---

---

---

---

---

---

---

---

---

---

---

---

---

---

---

---



The logo for Timberline By ELWELL is located in the top right corner. It features the word "Timberline" in a bold, white, sans-serif font, with a red horizontal bar through the letter "e". Below it, the words "By ELWELL" are written in a smaller, white, sans-serif font.

**Timberline**  
By ELWELL

The background of the entire advertisement is a photograph of a rugged mountain range. The peaks are covered in snow and are illuminated by a warm, golden light, likely from the setting or rising sun. The sky is a deep, dark blue with some wispy clouds. The overall mood is adventurous and serene.

**Go where  
you've never  
gone before.**

To explore all that Timberline has to offer visit:  
**[Timberlineheat.com](http://Timberlineheat.com) or [Elwellcorp.com](http://Elwellcorp.com)**

360-608-0916 | [info@elwellcorp.com](mailto:info@elwellcorp.com)  
680-C South 28th St. Washougal, WA 98671

All rights reserved ©